

Features & benefits

- Well-insulated
- Low pressure drop due to smooth inner surface
- Non-porous
- Airtight
- Doesn't rust
- Compact, mechanical connections (i.e. no tape or sealants required)
- Extremely light material
- Easy and safe to cut
- Pliable
- Impact resistant (i.e. no dents)
- Easy to dismantle for maintenance
- Zero carbon footprint
- BIM-ready



T-piece



Y-piece

Specifications	
Material	EPE
Density	30 kg/m ³
Heat transfer coefficient	0.041 W/m.K (EN 12667)
Thermal resistance	R = 0.39 m ² K/W
Temperature range	Min. -30°C Max. +60°C
Wall thickness	16 mm
Fire class	B1 (EN 4102)
Reaction to fire	Class E (EN 13501)
Function	Transport of air for ventilation and/or heating and/or cooling
Airtightness	D (EN 12237) = ATC 2 (EN 16798)
Colour	Grey
Material couplers and brackets	PP
Material Y-piece	EPP

Technical details

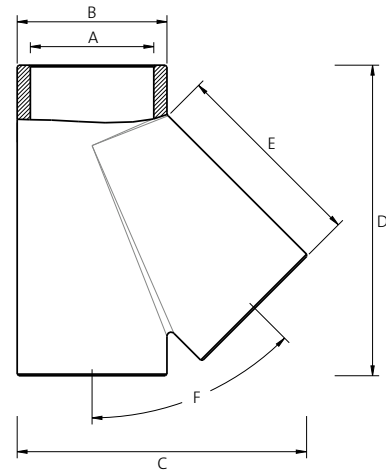
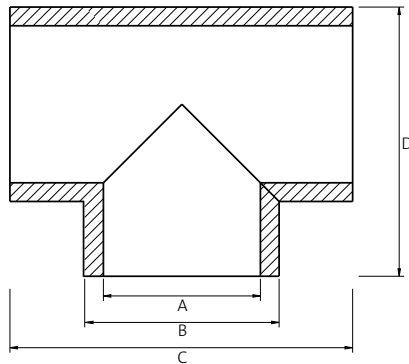

T-piece				
	125	150	160	180
A [mm]	125	-	160	-
B [mm]	157	-	192	-
C [mm]	276	-	316	-
D [mm]	216	-	254	-

Y-piece				
	125	150	160	180
A [mm]	-	150	-	180
B [mm]	-	182	-	212
C [mm]	-	352	-	410
D [mm]	-	377	-	440
E [mm]	-	240	-	278
F [°]	-	45	-	45